

REVISIONS			REVISIONS			REVISIONS		
DATE	NAME	LICENSE No.	DATE	NAME	LICENSE No.	DATE	NAME	LICENSE No.
APRIL 2007	HAROLD E. PELLOW	P.E.&L.S.#13229	DECEMBER 2013	HAROLD E. PELLOW	P.E.&L.S.#13229	DECEMBER 2016	HAROLD E. PELLOW	P.E.&L.S.#13229
MARCH 2010	HAROLD E. PELLOW	P.E.&L.S.#13229	DECEMBER 2014	HAROLD E. PELLOW	P.E.&L.S.#13229			
AUGUST 2011	HAROLD E. PELLOW	P.E.&L.S.#13229	DECEMBER 2015	HAROLD E. PELLOW	P.E.&L.S.#13229			

GREEN TOWNSHIP - SUSSEX COUNTY

BOROUGH OF ANDOVER
SUSSEX COUNTY

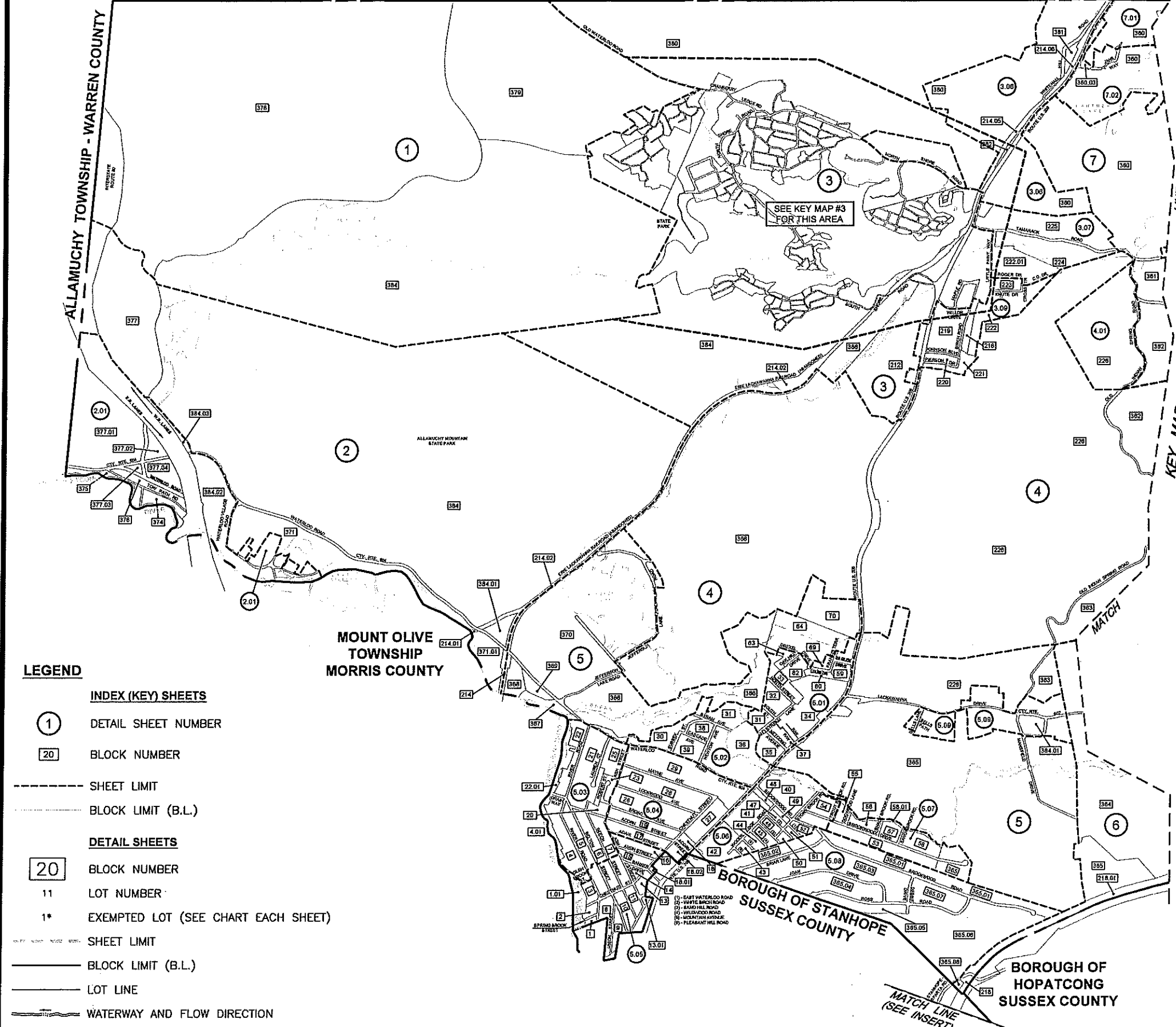

- LEGEND**
- INDEX (KEY) SHEETS**
- ① DETAIL SHEET NUMBER
 - 20 BLOCK NUMBER
 - SHEET LIMIT
 - BLOCK LIMIT (B.L.)
- DETAIL SHEETS**
- 20 BLOCK NUMBER
 - 11 LOT NUMBER
 - 1* EXEMPTED LOT (SEE CHART EACH SHEET)
 - SHEET LIMIT
 - BLOCK LIMIT (B.L.)
 - LOT LINE
 - WATERWAY AND FLOW DIRECTION

I hereby certify that this map has been created under my immediate supervision and complies with the laws of the State of New Jersey.

HAROLD E. PELLOW, P.E. & L.S.
PROFESSIONAL ENGINEER AND LAND SURVEYOR, N.J. LIC. NO.13229

DATE: _____

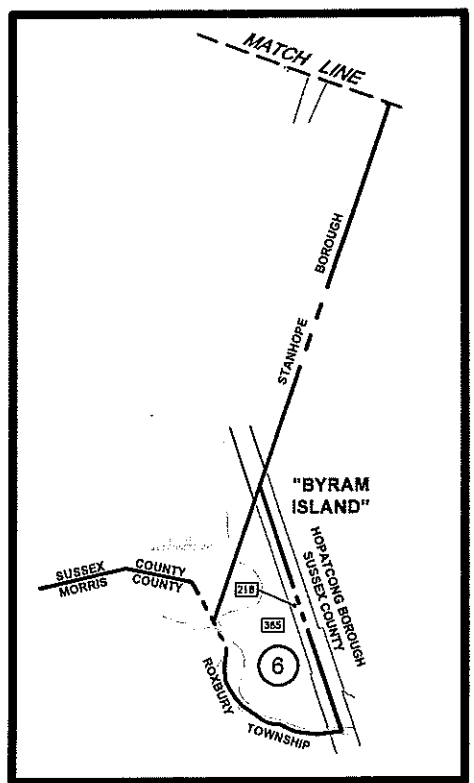

- MAP REFERENCES:**
1. THIS MAP SUPERSEDES THE MAP DATED JAN. 25, 1963.
 2. THE DETAILS SHOWN ON THESE MAPS ARE BASED ON THE APPROVED ORIGINAL TAX MAPS AND THE GENERAL REVISIONS THERETO, PRIOR TO JUNE 2006. FOR REVISIONS AND CONDITIONS PRIOR TO JUNE 2006, SEE APPROVED ORIGINAL MAPS ON FILE IN THE MUNICIPAL TAX ASSESSOR'S OFFICE.
 3. THE AREAS, BOUNDARIES, AND DIMENSIONS SHOWN ON THESE MAPS ARE DERIVED FROM AERIAL SURVEYS, RECORDED PLANS, MAPS, DEEDS, AND WILLS AND ARE TO BE USED FOR ASSESSMENT PURPOSES ONLY.

THESE MAPS SCALED TO FIT 11"x17"

TAX MAP
TOWNSHIP OF BYRAM
SUSSEX COUNTY, NEW JERSEY
SCALE: 1" = 1,000' JUNE 2006
Prepared By
HAROLD E. PELLOW
NEW JERSEY PROFESSIONAL ENGINEER AND
LAND SURVEYOR, L.I.C. #13229
HAROLD E. PELLOW & ASSOCIATES, INC.
17 PLAINS ROAD, AUGUSTA, NEW JERSEY
*TO SHOW CONDITIONS AS OF DEC. 2018

DECEMBER 2016	
DECEMBER 2014	
DECEMBER 2013	
AUGUST 2011	
MARCH 2010	
DATE	DATE
REVISED	
HAROLD E. PELLOW & ASSOCIATES INC. HAROLD E. PELLOW - N.J. PROFESSIONAL ENGINEER & LAND SURVEYOR, LIC. NO. 13229	

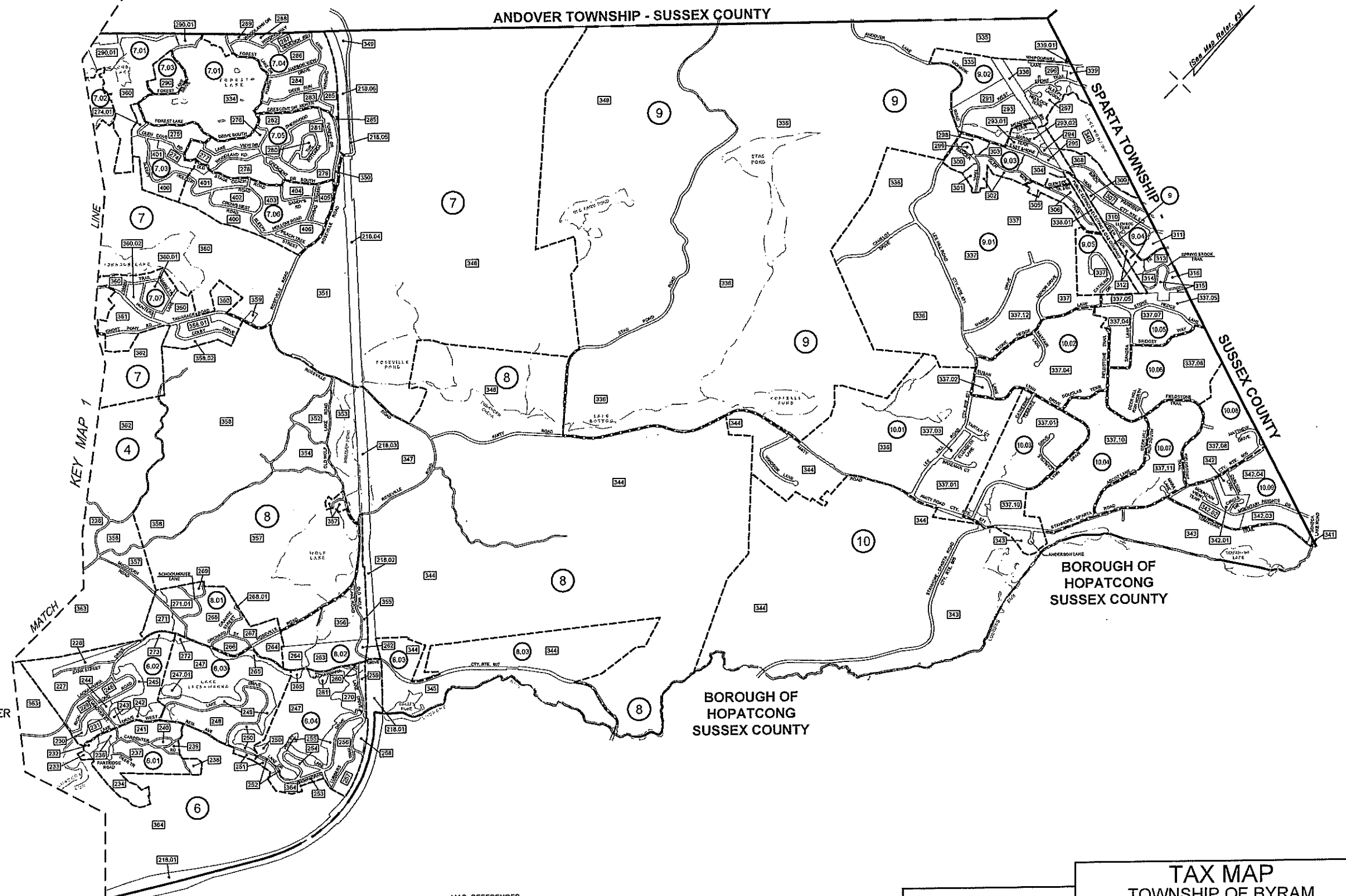

- LEGEND**
- INDEX (KEY) SHEETS**
 - ① DETAIL SHEET NUMBER
 - 20 BLOCK NUMBER
 - SHEET LIMIT
 - BLOCK LIMIT (B.L.)
 - DETAIL SHEETS**
 - 20 BLOCK NUMBER
 - 11 LOT NUMBER
 - * EXEMPTED LOT (SEE CHART EACH SHEET)
 - SHEET LIMIT
 - BLOCK LIMIT (B.L.)
 - LOT LINE
 - ~ WATERWAY AND FLOW DIRECTION

I hereby certify that this map has been created under my immediate supervision and complies with the laws of the State of New Jersey

HAROLD E. PELLOW, P.E. & L.S.
PROFESSIONAL ENGINEER AND LAND SURVEYOR, N.J. LIC. NO. 13229

DATE: _____

- MAP REFERENCES:**
- THIS MAP SUPERSEDES THE MAP DATED JAN. 25, 1963.
 - THE DETAILS SHOWN ON THESE MAPS ARE BASED ON THE APPROVED ORIGINAL TAX MAPS AND THE GENERAL REVISIONS THERETO, PRIOR TO JUNE 2006. FOR REVISIONS AND CONDITIONS PRIOR TO JUNE 2006, SEE APPROVED ORIGINAL MAPS ON FILE IN THE MUNICIPAL TAX ASSESSOR'S OFFICE.
 - THE AREAS, BOUNDARIES, AND DIMENSIONS SHOWN ON THESE MAPS ARE DERIVED FROM AERIAL SURVEYS, RECORDED PLANS, MAPS, DEEDS, AND WILLS AND ARE TO BE USED FOR ASSESSMENT PURPOSES ONLY.

TAX MAP
TOWNSHIP OF BYRAM
SUSSEX COUNTY, NEW JERSEY
SCALE: 1" = 1,000' JUNE 2006
Prepared By
HAROLD E. PELLOW
NEW JERSEY PROFESSIONAL ENGINEER AND
LAND SURVEYOR, LIC. #13229
HAROLD E. PELLOW & ASSOCIATES, INC.
17 PLAINS ROAD, AUGUSTA, NEW JERSEY
* TO SHOW CONDITIONS AS OF DEC. 2016

DECEMBER 2016	
DECEMBER 2015	
DECEMBER 2014	
DECEMBER 2013	
MARCH 2010	
DATE	DATE
REVISED	
HAROLD E. PELLOW & ASSOCIATES INC. HAROLD E. PELLOW - N.J. PROFESSIONAL ENGINEER & LAND SURVEYOR, LIC. NO. 13229	

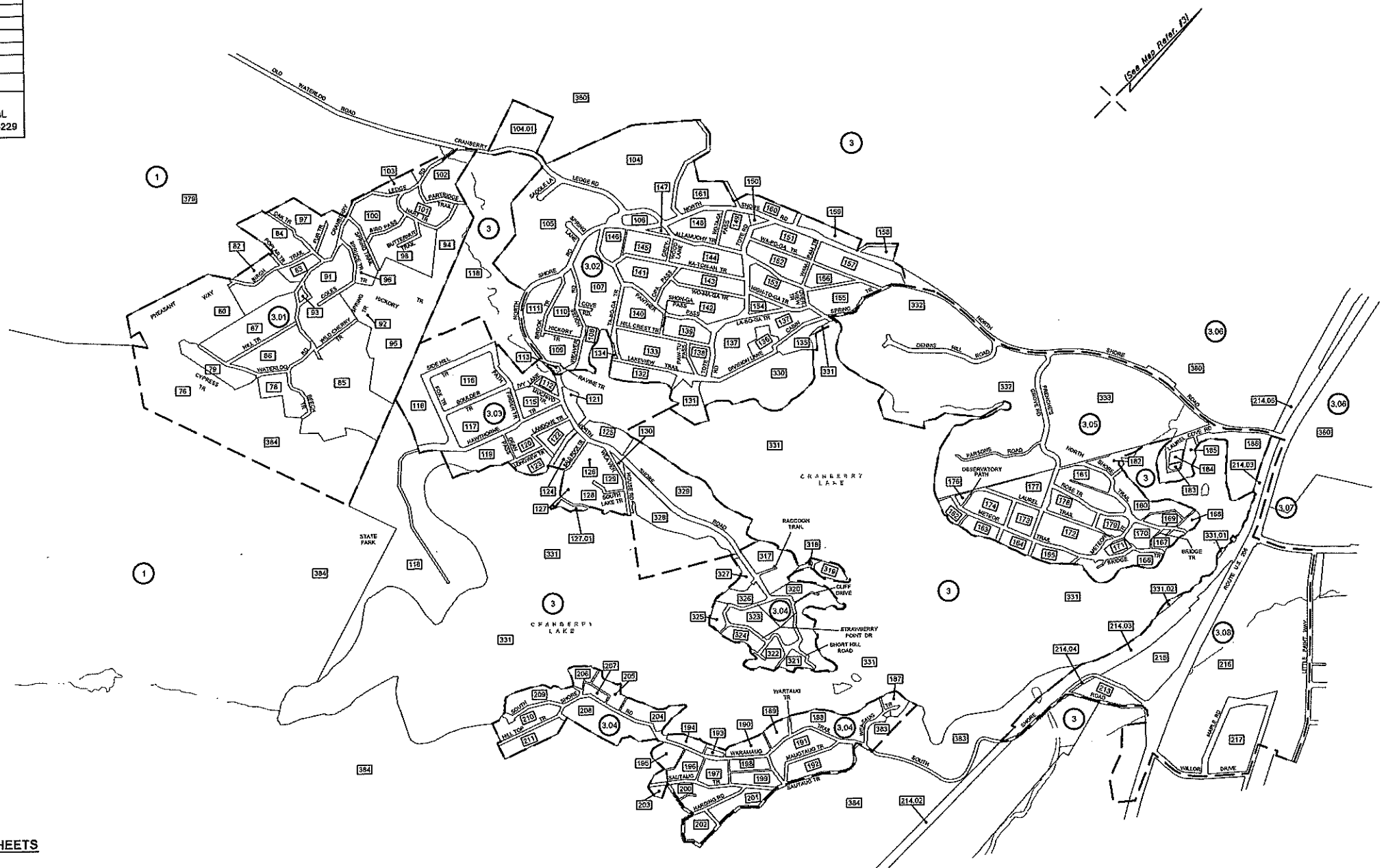

- LEGEND**
- INDEX (KEY) SHEETS
- ① DETAIL SHEET NUMBER
 - 20 BLOCK NUMBER
 - SHEET LIMIT
 - BLOCK LIMIT (B.L.)
- DETAIL SHEETS
- 20 BLOCK NUMBER
 - 11 LOT NUMBER
 - 1* EXEMPTED LOT (SEE CHART EACH SHEET)
 - SHEET LIMIT
 - BLOCK LIMIT (B.L.)
 - LOT LINE
 - ~~~~~ WATERWAY AND FLOW DIRECTION

I hereby certify that this map has been created under my immediate supervision and complies with the laws of the State of New Jersey

HAROLD E. PELLOW, P.E. & L.S.
PROFESSIONAL ENGINEER AND LAND SURVEYOR, N.J. LIC. NO. 13229

DATE: _____

- MAP REFERENCES:**
- THIS MAP SUPERSEDES THE MAP DATED JAN. 25, 1963.
 - THE DETAILS SHOWN ON THESE MAPS ARE BASED ON THE APPROVED ORIGINAL TAX MAPS AND THE GENERAL REVISIONS THERETO, PRIOR TO JUNE 2006. FOR REVISIONS AND CONDITIONS PRIOR TO JUNE 2006, SEE APPROVED ORIGINAL MAPS ON FILE IN THE MUNICIPAL TAX ASSESSOR'S OFFICE.
 - THE AREAS, BOUNDARIES, AND DIMENSIONS SHOWN ON THESE MAPS ARE DERIVED FROM AERIAL SURVEYS, RECORDED PLANS, MAPS, DEEDS, AND WILLS AND ARE TO BE USED FOR ASSESSMENT PURPOSES ONLY.

TAX MAP
TOWNSHIP OF BYRAM
SUSSEX COUNTY, NEW JERSEY
SCALE: 1" = 400' JUNE 2006

Prepared By
HAROLD E. PELLOW
NEW JERSEY PROFESSIONAL ENGINEER AND
LAND SURVEYOR, LIC. #13229
HAROLD E. PELLOW & ASSOCIATES, INC.
17 PLAINS ROAD, AUGUSTA, NEW JERSEY
* TO SHOW CONDITIONS AS OF DEC. 2016